

EVERETT SCHOOL DISTRICT NO. 2

EISENHOWER MIDDLE SCHOOL PARTIAL
NEW CONSTRUCTION IN LIEU OF MODERNIZATION

RESOLUTION NO. 796

A RESOLUTION certifying that portions of the existing facilities identified in the project application (Form D-3) submitted to the Office of Superintendent of Public Instruction on August 11, 2003 will be surplus and replaced in lieu of modernization of existing facilities and that those portions of the existing facilities will not be used in the future for instructional purposes or be eligible for future state financial assistance.

WHEREAS, the Everett School District has undertaken a project to expand and modernize Eisenhower Middle School; and

WHEREAS, both local and state funds will be used for this project; and;

WHEREAS, there are laws and rules regarding District eligibility for state assistance; and;

WHEREAS, it is required that the District certify per WAC 180-33-042 that the existing facility or space to be replaced will not be used for instructional purposes after the new construction is completed, and that the facility or space will be ineligible for any future financial assistance;

THEREFORE, BE IT RESOLVED that the Everett School District will be demolishing the existing faculty lounge, music rooms, administration areas and one general-purpose classroom consisting of 11,076 square feet that will be replaced by a new facility, and 83,790 square feet will be retained for modernization.

ADOPTED this 25 of May, 2004, and authenticated by the signatures affixed below.

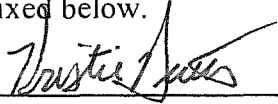

Kristie Dutton
President, Board of Directors



Paul Roberts, Vice-President



Sue Cooper, Member



Karen Madsen, Member

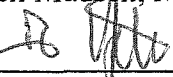

Roy Yates, Member

ATTESTED BY:

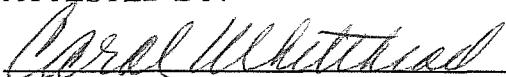

Carol Whitehead, Ed. D.
Secretary, Board of Directors

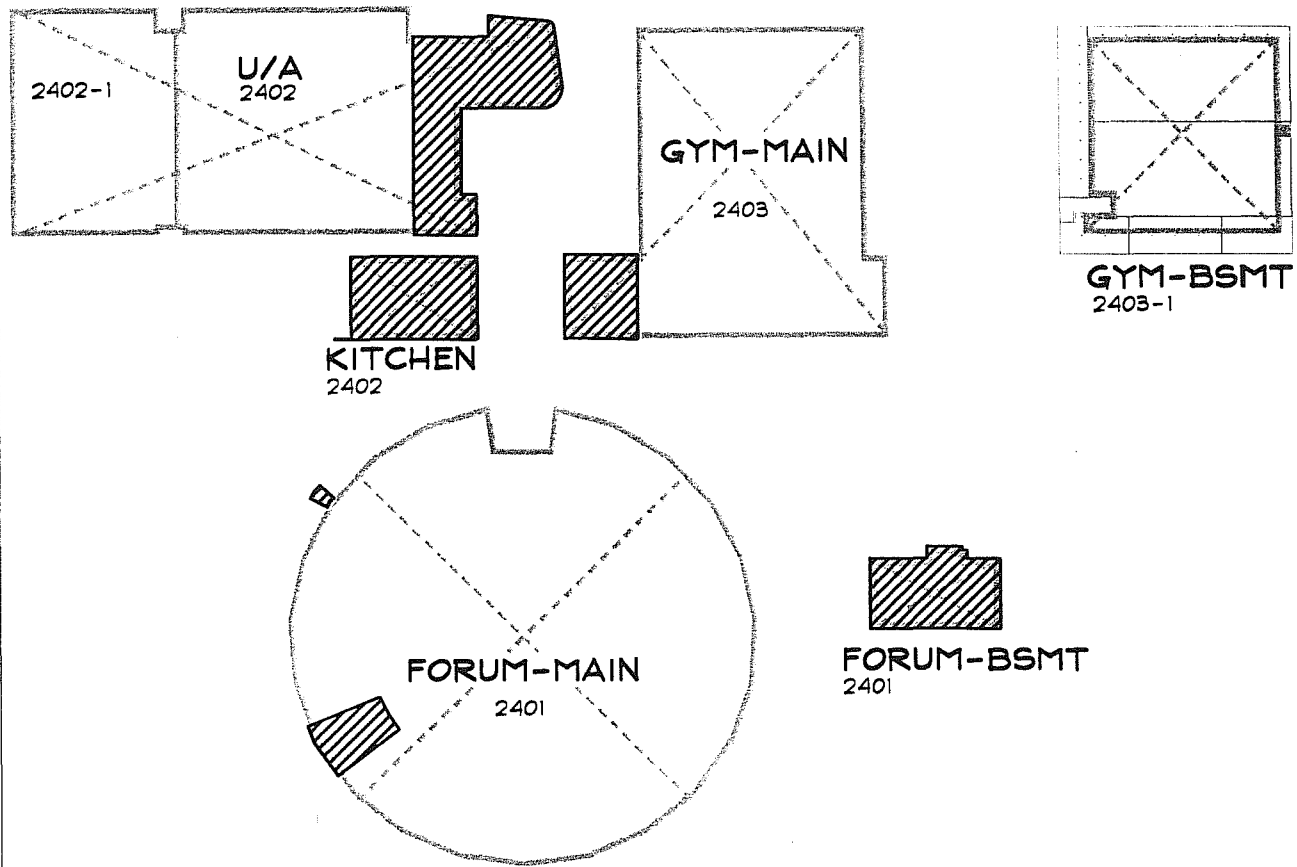

DEMOLITION AREA SF CALCULATIONS

Number	Area	Year	SQ. FT.
2401	FORUM	1971	
	Main		< 857 > sf
	Sprinkler Riser Room		< 59 > sf
	Bsmt		< 2,204 > sf
2402	U/A	1971	< 4,151 > sf
	Kitchen		< 2,392 > sf
2402-1	Addition	1980	0 sf
2403	GYM	1971	
	Main		< 1,413 > sf
2403-1	Addition/ Bsmt	1980	0 sf
Sub-Total Demolition Area =			< 11,076 > sf

Existing Building Area = 94,866 sf

Total Modernization Area = 83,790 sf



720 MARKET ST., SUITE H,
KIRKLAND, WA. 98033
phone: 425.828-8948
fax: 425.828-9067

Job No. 0310
Date 5/11/04
Drawn By GEB
Rev.

Project Name: Eisenhower Middle School
Everett School District No. 2
Subsection Name: No.
DEMOLITION AREA SF CALCULATIONS

Page No.

SF-2